

2712

\$1,175,000

CASTNET RD

JOHNS ISLAND



PROPERTY FEATURES:



3 Bedroom



2.5 Bathrooms



Tidal Creek



NO HOA

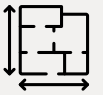

1,860 Sq Ft

ABOUT:

Welcome to this breathtaking Lowcountry 3 Bed/2.5 bath retreat situated on 1.06 acres providing ultimate privacy & stunning water views of the Abbapoola Creek! NO HOA!! Enjoy the luxury of a private floating dock, perfect for boating and fishing as the creek winds out to the Stono River!!



GREATER
CHARLESTON
PROPERTIES TEAM



CHRISTOS PALLES

843-568-9794

christos.charlestonproperties@gmail.com

christos.findhomesforsaleincharleston.com





**GREATER
CHARLESTON**
PROPERTIES TEAM

Interior



Step inside to a spacious open floor plan adorned with elegant tray ceilings and new flooring throughout, including tile and wood. The modern kitchen is a chef's delight with new countertops, eat-ins island/bar, stylish tile backsplash and stainless steel appliances!! The primary suite is located off of the main living area and features a tray ceiling, large walk-in closet, en-suite primary bath, and breathtaking views of the creek with private outside access!! The primary bathroom boasts dual vanities, quartz countertop, custom tile walk-in shower, new fixtures and a garden/soaking tub! The other two bedrooms are both good in size and offer walk-in closets and plenty of space for visiting friends/family!



**GREATER
CHARLESTON**
PROPERTIES TEAM

Exterior



Step outside and you will find that outdoor living is truly at its finest with a fully fenced yard, NEW porch with pillars, covered deck, and a rear split-level section overlooking the backyard and creek. Entertain your guests with an outdoor kitchen, bar, shower, and enjoy the detached workshop with new flooring for your projects and hobbies!! Step through the gate in the backyard and head down the walkway to find your own private floating dock with a jet dock and drive-on ramp. The property sits directly on the Abbapoola creek which measures around 6-7ft at high tide for easy access out to the ocean!!

UPGRADES & EXTRAS

2712 Castnet Rd



- 1.06 acres
- Stunning water views of Abbapoola Creek
- NO HOA
- Private floating dock with jet dock and drive-on ramp
- Boat storage
- Workshop with new flooring
- Tankless Rinnai water heater
- New flooring throughout
- New metal roof
- Fully fenced yard
- New porch with pillars
- Covered deck
- Rear split-level section overlooking the backyard and creek
- Outdoor kitchen, bar, and shower
- 300 Amp service panel
- New ductwork in the attic with blown insulation
- New appliances (washer, dryer, microwave - 2022)
- Updated HVAC system (2021)
- Updated plumbing for gas appliances
- Energy-efficient windows and doors
- Sunlit ceilings in some rooms
- 15 minutes from Kiawah Island
- 20 minutes from downtown Charleston



**GREATER
CHARLESTON**
PROPERTIES TEAM